

APPENDIX 'A'

- Notes**
- Construction period estimated at five weeks, during this time existing licenses for fast food stalls will need to be revoked.
 - Fast food stalls would need to be informed of works prior to start of construction.
 - Electrical disconnection would be required for existing pumps.

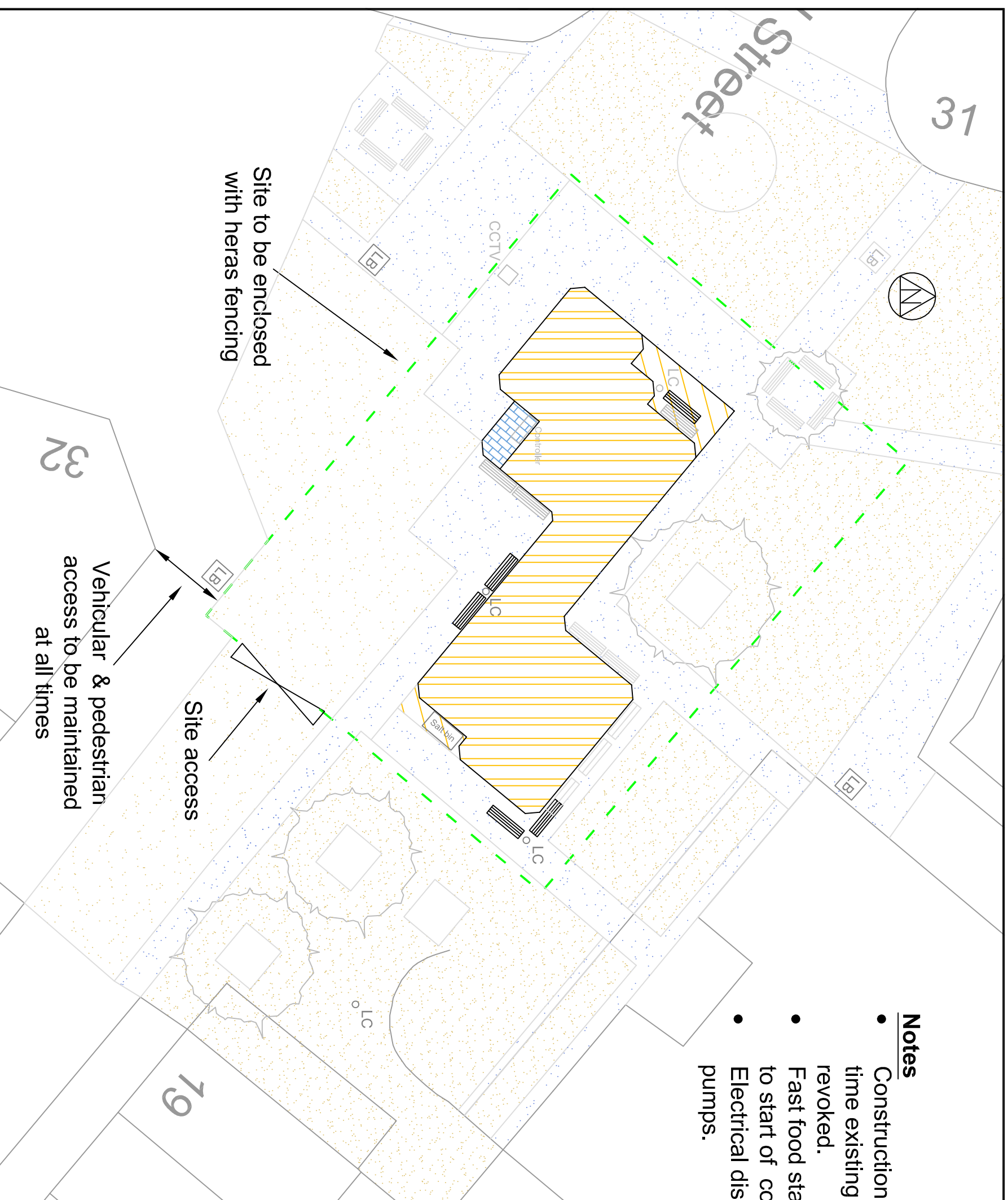

Market Hall

	New concrete paving flags in natural colour to match existing paved areas
	Existing concrete flags to remain.
	Existing blue block paving surrounding fountain footprint. Blocks to remain where possible or be relaid.
	Existing block paving to remain.
	Proposed concrete flags in place of existing blue blocks.
	Proposed blue blocks in area of fountain footprint.
	Existing bench / seat location
	Proposed re-used bench location
	Existing lighting columns

<p>Rotherham Metropolitan Borough Council Environment & Development Services</p> <p>Strategic Director: Karl Battersby Bsc (Hons) MTRP MRPI</p>		<p>Rotherham Metropolitan Borough Council Environment & Development Services Bailey House, Rawmarsh Road, Rotherham S60 1TD</p>		Client:	
Rev.	Description	<p>Title HOWARD STREET, ROTHERHAM TOWN CENTRE 'BOOTS' FOUNTAIN REMOVAL</p> <p>Dwg. No. 123/M166 Rev. Scales (if A3) 1:200</p> <p>Drawn NF Date November 2010 Chd. by</p>			